

SHENYANG BLUELIGHT

沈阳蓝光，伴你飞翔
DRIVE THE FUTURE



- 华南办事处
电话: 13940069968
South China office
Tel: 13940069968
- 华东办事处
电话: 18602456256
East China office
Tel: 18602456256
- 德州办事处
电话: 13940437228
Dezhou office
Tel: 13940437228
- 外贸部
电话: 86-024-23780807-717, 86-024-83786420
邮箱: zhangruiyan@sylg.cn
FOREIGN TRADE CENTER
Tel: 86-024-23780807-717, 86-024-83786420
E-mail: zhangruiyan@sylg.cn



[HTTP://WWW.SYLG.CN](http://www.sylg.cn)

2022年11月修订

Revised November 2022

样本信息仅供参考

Sample Information For Reference Only

沈阳蓝光驱动技术有限公司

电话: 024-83863349

地址: 沈阳市浑南新区世纪路37号

邮编: 110179

Shenyang Bluelight Drive Technology Co.,Ltd.

TEL: 024-83863349

ADD: No.37 Shiji Road, Hunnan New District,
Shenyang, China ZIP: 110179

公司简介 About us

- 沈阳蓝光集团成立于 1989 年，是专业从事电梯控制系统和永磁同步无齿轮电梯曳引机开发、生产的高科技企业。是中国电梯协会理事单位、ISO9001 认证企业。
- 沈阳蓝光驱动技术有限公司在广东肇庆及浙江南浔均建有生产基地，其中肇庆厂区 1 万平方米，年产 3 万台；浙江南浔厂区 1 万平方米，年产 3 万台。
- 沈阳蓝光从 1998 年开始永磁同步无齿轮电梯曳引机产品的研制开发工作，组成了由两名电机学博士为主的课题组，投入大量人力、物力，先后同国内高校和国外知名企业开展技术合作，于 2000 年 10 月研制成功首台永磁同步无齿轮电梯曳引机并投入试运行。此后又经过多次重大技术、工艺改进，于 2001 年 7 月率先在国内通过国家电梯质量检测中心检验，并取得认证证书，产品投入批量生产。沈阳蓝光获得了永磁同步无齿轮电梯曳引机多项国家专利，拥有该项产品技术的全部自主知识产权。
- 到目前为止，蓝光集团生产的永磁同步无齿轮电梯曳引机产品在全国各地被广泛使用，部分产品远销到欧洲、美洲、韩国、日本、台湾、中东、东南亚等国家和地区。由于蓝光曳引机具有运行噪音低、振动小、运行舒适平稳等特点，深受广大电梯制造厂商的青睐。
- Established in 1989, Bluelight is a leading manufacturer of elevator control systems and gearless permanent magnet synchronous machines. It is member of China Elevator Association and an enterprise certified by ISO9001.
- Shenyang BlueLight has also built production base in Guangdong and Zhejiang province. Guangdong Plant has floor space of 10,000 m² with annual production capacity 30,000 units. Zhejiang Plant has floor space of 10,000 m² with annual production capacity 30,000 units.
- From 1998, Shenyang Bluelight started development of gearless permanent magnet synchronous machines. With a R&D team leading by two doctors experts in motor, Bluelight cooperated constantly with domestic universities, overseas well-known companies for exchange of technology and successfully developed the first gearless permanent magnet synchronous machines in October, 2000. After several technical improvements, Bluelight passed the national EMC testing in July, 2001 and successfully obtained certification. Meanwhile, the machines had been launched into mass production. Shenyang Bluelight has granted several patents of gearless permanent magnet synchronous machines and owned all the knowledge property rights.
- Nowadays, Bluelight gearless machines are widely used in China and some of the products have been sold to Europe, America, Korea, Japan, Taiwan, Middle East, Southeast Asia etc. Relying on the excellent characteristics such as low noise, low vibration, smooth and comfortable running etc., Bluelight gearless machines are being recognized by more and more elevator manufacturers.



沈阳总部
Shenyang Head Quarters



苏州工厂
Suzhou Plant



肇庆工厂
Zhaoqing Plant



抚顺工厂
Fushun Plant



浙江工厂
Zhejiang Plant

智慧与力量 COMPANY QUALIFICATION

- 1.质量管理体系认证 | ISO9001
- 2.韩国KTL认证KC证书 | KTL Issue KC Certification
- 3.国家高新技术企业认证 | National high-tech Enterprise
- 4.全国发明展览会银奖 | China Invention Exhibition
- 5.特种设备型式实验合格证 | Type-examination Certificate of Special Equipment
- 6.中华人民共和国专利证书 | Patent Certificate
- 7.CE证书 | CE Certification



1



2



3



4

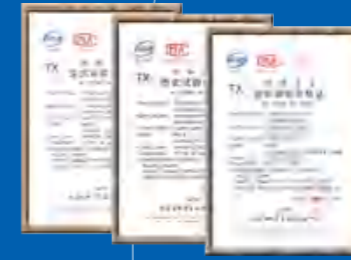

5

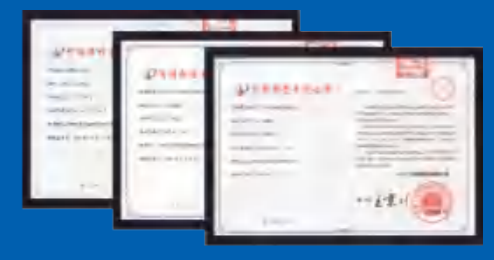

6



7



01 标准系列 WYT - T STANDARD SERIES

- WYT-T 永磁同步曳引机
(轻载款/标准款/高性能款/重载款)
WYT-T PM TRACTION MACHINE (TS/TF/TD/TE)
----- 01/06

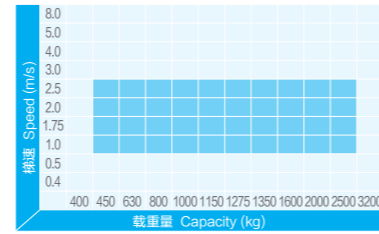

02 静音系列 WYT - L / F COMFORTABLE SERIES

- WYT-L 无机房款
WYT-L MACHINE ROOMLESS VERSION
----- 07/08

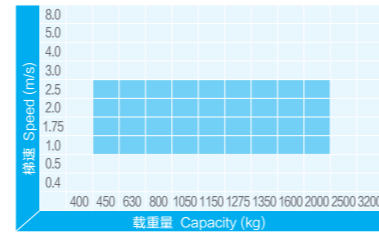

- WYT-F 别墅梯款
WYT-F VILLA VERSION
----- 09/12

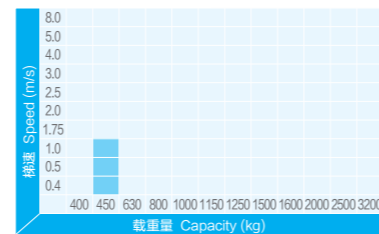

03 大载重系列 WYT - V / V1S / U PM TRACTION MACHINE

- WYT-V
WYT-V
----- 13/14

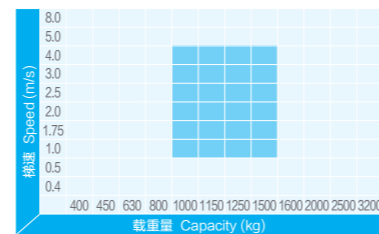

- WYT-V1S
WYT-V1S
----- 15/16

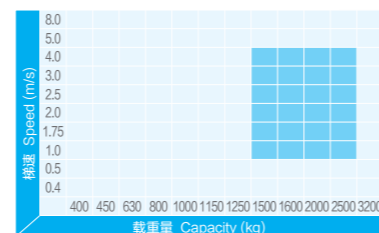

- WYT-U 永磁同步曳引机
WYT-U PM TRACTION MACHINE
----- 17/18

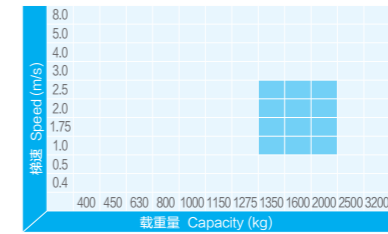

04 高速系列 WYT - H / Y HIGH SPEED SERIES

- WYT-H 超高速款
WYT-H ULTRA-HIGH SPEED VERSION
----- 19/20

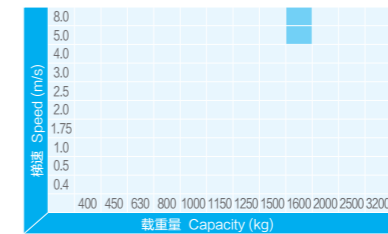

- WYT-Y 单/复绕款
WYT-Y SINGLE/DOUBLE WRAP VERSION
----- 21/24

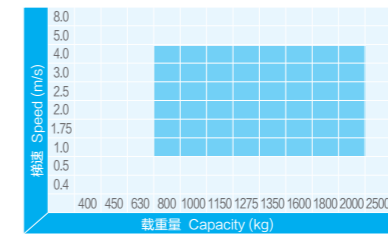

05 钢带系列 SYLG-EB HOISTING BELT SERIES

- SYLG-EB 电梯曳引钢带
SYLG-EB HOISTING BELT FOR ELEVATOR
----- 25/26



曳引机选型表 MACHINE TYPE RECOMMENDATION TABLE

标准系列 WYT-T

STANDARD SERIES



WYT-T

永磁同步曳引机

WYT-T PM Traction Machine

WYT-T系列是我司主力推出的经典款外转子永磁同步曳引机。此系列经过10余年的不断改善，产品质量非常稳定，性能指标国内领先，产品覆盖范围极广，成为现在高性能电梯的首选产品。

WYT-T series outer rotor PMS machine is Bluelight's most popular product. After 10 years of continuous improvement, this series product has high quality standard, with superior performance, and can cover wide range of elevator application. It is your first choice for high performance elevator.

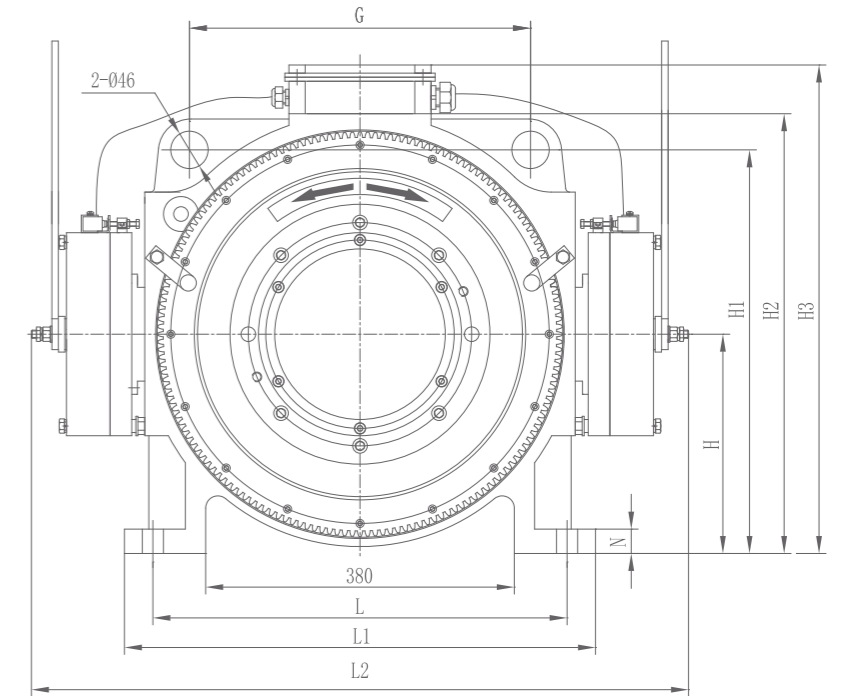
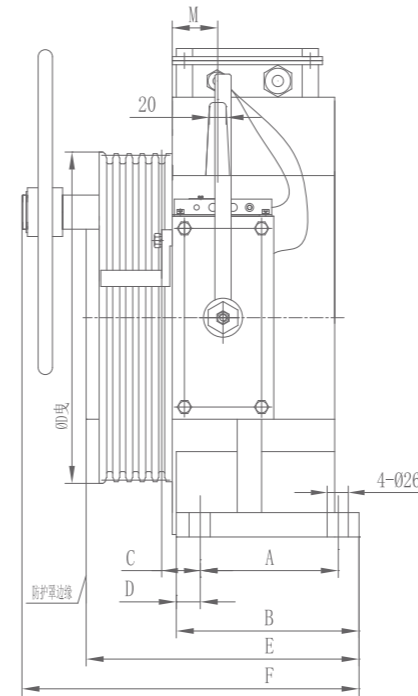

外观尺寸图 | Outline drawing

主机技术参数 (Parameter of Traction Machine)

- 额定电压 (Voltage) : AC380V
- 悬挂比 (Roping) : 2: 1
- 钢丝绳绕法 (Wrap) : 单绕 (Single)
- 额定载重量 (Capacity) : 450kg ~ 2500kg
- 轿厢速度 (Speed) : 1.0m/s ~ 2.5m/s
- 防护等级 (Protection Grade) : IP41
- 绝缘等级 (Ins. Class) : F
- 曳引机极数 (Traction machine pole): 30
- 启动频次 (次/小时, Stars per hour): 240
- 工作制 (Rating): S5-40%

特点 (Features)

- 合理的机械结构设计，轴负荷大，运行安全系数高；
- 高效率、高转矩密度设计，优化的极槽配合；
- 主机运行平稳，噪音低，振动小；
- 轿厢速度、载重量覆盖广；
- 采用无闸臂块式制动器，响应快，可靠性高。
- Optimized mechanical structure design, high shaft load, high operating safety factor;
- High efficiency, high torque density design and optimized pole slot coordination;
- Machine run smoothly, with low noise & small vibration;
- This series covers wide range of elevator speed & capacity.
- Use block type armless brake, it has fast response time & high reliability.

制动器技术参数 (Parameter of Brake)

型号 (Model) : BLB 绝缘等级 (Ins.Class) : F 额定电压 (Voltage) : DC110V
 额定电流 (Current) :

系列 Series	型号 Model	梯速(m/s) Speed	载重代号 Capacity code	额定电流 Current	
WYT-T		1.0~2.0	A, B, AS, BS, CS, DS(450kg ~ 1000kg)	1.1A	
			C, CL, D, DL, E (630kg ~ 1150kg)	1.3A	
	D	1.0~2.5	C, CL, D, DL, E, EL(800kg ~ 1150kg)	1.6A	
		1.0~1.75	F, FL, G, GL, H (1275kg ~ 1600kg)		
		E	1.0~2.0	C, D, E, F(1275kg ~ 2000kg)	1.6A
			1.0~2.5	CL, DL, EL(1275kg ~ 1600kg)	
1.0~2.5	FL(2000kg)		1.98A		
1.0~2.0	G, GL(2500kg)				

WYT-TS 轻载款 \ WYT-TS Light Duty Version

推荐提升高度(Height): ≤80m

系列 Series	型号 Model	载重 Capacity (kg)	轿厢速度 Speed (m/s)	曳引轮直径 Sheave (mm)	槽数 Num	绳径 (mm)	槽间距 Pitch (mm)	额定电流 (A)	额定转速 (rpm)	额定频率 (Hz)	额定功率 (kW)	额定转矩 (Nm)	最大轴负荷 Shaft Load (kg)	主机重量 Weight (kg)	安装尺寸 Dimension(mm)															
															A	B	C	D	E	F	G	H	H1	H2	H3	L	L1	L2	M	N
WYT-T	1.0AS	450	1.0	φ350	5	φ8	12	7.2	109	27.3	3.1	270	2500	≈300	140	195	47.5	29.5	328	390	420	270	497	540	605	510	580	800	56	30
	1.5AS		11					164	41	4.6																				
	1.6AS		11.3					175	43.7	4.9																				
	1.75AS		11.7					191	47.7	5.4																				
	1.0BS	630	1.0	φ350	5	φ8	12	9.4	109	27.3	4.2	370	2500	≈300	140	195	47.5	29.5	328	390	420	270	497	540	605	510	580	800	56	30
	1.5BS		15.2					164	41	6.4																				
	1.6BS		15.4					175	43.7	6.8																				
	1.75BS		16.1					191	47.7	7.4																				
	1.0CS	800	1.0	φ350	6	φ8	12	12	109	27.3	5.3	460	3000	≈300	140	195	47.5	29.5	328	390	420	270	497	540	605	510	580	800	56	30
	1.5CS		20.2					164	41	7.9																				
	1.6CS		20.5					175	43.7	8.4																				
	1.75CS		20.8					191	47.7	9.2																				
	1.0DS	1000	1.0	φ350	6	φ8	12	14.4	109	27.3	6.4	560	3000	≈300	140	195	47.5	29.5	328	390	420	270	497	540	605	510	580	800	56	30
	1.5DS		23.8					164	41	9.6																				
	1.6DS		24.2					175	43.7	10.3																				
1.75DS	25		191					47.7	11.2																					

此系列主机推荐槽型: 单绕V型槽
Recommended single groove V

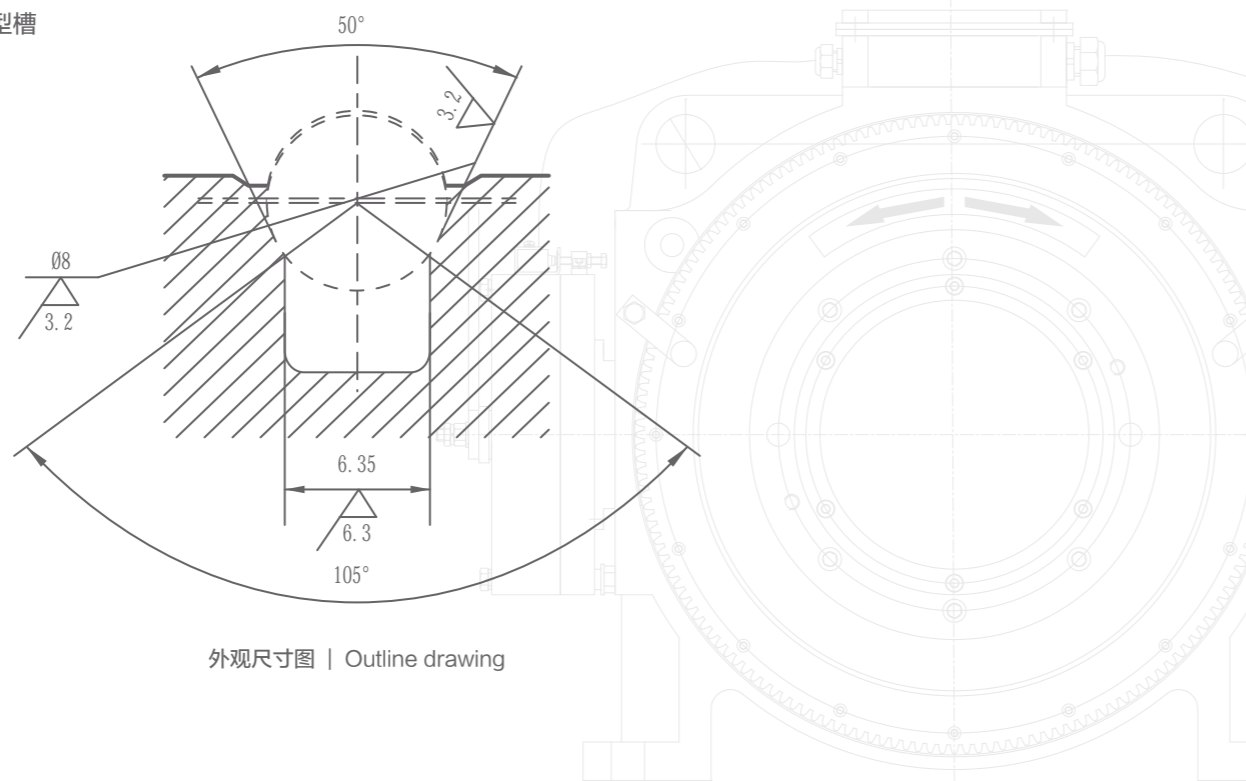

WYT-TF 标准款 \ WYT-TF Standard Version

推荐提升高度(Height): ≤90m

系列 Series	型号 Model	载重 Capacity (kg)	轿厢速度 Speed (m/s)	曳引轮直径 Sheave (mm)	槽数 Num	绳径 (mm)	槽间距 Pitch (mm)	额定电流 (A)	额定转速 (rpm)	额定频率 (Hz)	额定功率 (kW)	额定转矩 (Nm)	最大轴负荷 Shaft Load (kg)	主机重量 Weight (kg)	安装尺寸 Dimension(mm)															
															A	B	C	D	E	F	G	H	H1	H2	H3	L	L1	L2	M	N
WYT-T	1.0A	450	1.0	φ400	4	φ10	16	7.5	96	24	3.2	320	2500	≈300	140	195	47.5	29.5	328	390	420	270	497	540	605	510	580	800	56	30
	1.5A		11					144	36	4.8																				
	1.6A		11.4					153	38.3	5.1																				
	1.75A		12.1					168	42	5.6																				
	2.0A	630	2.0	φ400	4	φ10	16	14.2	192	48	6.4	460	2500	≈300	140	195	47.5	29.5	328	390	420	270	497	540	605	510	580	800	56	30
	1.0B		10.2					96	24	4.6																				
	1.5B		16.4					144	36	6.9																				
	1.6B		16.8					153	38.3	7.4																				
	1.75B	800	1.75	φ400	5	φ10	16	17.6	168	42	8.1	520	3000	≈330	140	195	47.5	29.5	328	390	420	270	497	540	605	510	580	800	56	30
	2.0B		20					192	48	9.3																				
	1.0C		11.8					96	24	5.2																				
	1.5C		19.8					144	36	7.8																				
	1.6C	800	1.6	φ400	5	φ10	16	20.2	153	38.3	8.3	520	3000	≈330	140	195	47.5	29.5	328	390	420	270	497	540	605	510	580	800	56	30
	1.75C		20.5					168	42	9.1																				
	2.0C		22.7					192	48	10.5																				
	1.0CL		11					80	19.9	5.1	605																			
	1.5CL	800	1.5	φ480	5	φ10	16	20.2	119	29.8	8.3	665	3500	≈330	140	195	47.5	29.5	328	390	420	270	497	540	605	510	580	800	56	30
	1.6CL		20.6					127	31.8	8.8																				
	1.75CL		21					139	34.8	9.7																				
	2.0CL		23.8					159	39.8	11																				
	1.0D	1000	1.0	φ400	5	φ10	16	13.6	96	24	6.1	605	3500	≈350	170	225	47.5	29.5	358	420	420	270	497	540	605	510	580	800	56	30
	1.5D		24.8					144	36	10																				
	1.6D		25.3					153	38.3	10.7																				
	1.75D		26					168	42	11.7																				
2.0D	1000	2.0	φ400	5	φ10	16	29.6	192	48	13.4	665	3500	≈350	170	225	47.5	29.5	358	420	420	270	497	540	605	510	580	800	56	30	
1.0DL		14.9					80	19.9	6.7																					
1.5DL		24.7					119	29.8	10																					
1.6DL		25					127	31.8	10.7																					
1.75DL	1000	1.75	φ480	5	φ10	16	25.4	139	34.8	11.7	800	3500	≈350	170	225	47.5	29.5	358	420	420	270	497	540	605	510	580	800	56	30	
2.0DL		28.7					159	39.8	13.3																					
1.0E		17					96	24	7.7																					
1.5E		28.1					144	36	11.5																					
1.6E	1150	1.6	φ400	6	φ10	16	28.5	153	38.3	12.3	765	3500	≈350	170	225	47.5	29.5	358	420	420	270	497	540	605	510	580	800	56	30	
1.75E		29.3					168	42	13.4																					
2.0E		32.7					192	48	15.4																					

静音系列 WYT-L/F COMFORTABLE SERIES



WYT-L 无机房款 WYT-L Machine Roomless Version



WYT-L 系列产品是我司 2019 年研发的新一代内转子结构的永磁同步曳引机，尤其适用于小机房或无机房。WYT-L 系列主机标准产品为 3 级能效，可根据客户要求提供 2 级能效产品。

WYT-L series products are the new generation inner rotor structure PM gearless traction machine developed by Bluelight in 2019. It is suitable for mini machine room or machine roomless elevator application. The standard products of the WYT-L series are level 3 energy efficiency, and can provide level 2 energy efficiency products according to customer requirements.

特点 (Features)

- 针针对无机房和小机房进行特殊静音设计；
- 针对某些顶层高度不足接线困难的现场标配可移动接线盒；
- 散热效果好，效率高；
- 高转矩密度设计，材料利用率高，体积小重量轻；
- 电磁结构优化，低速运行平稳，过载能力强；
- 采用轴刹制动器，结构紧凑，制动噪音低，响应速度快；

- Special silent design for MMR or MRL.
- For some sites where the top level is insufficient and difficult to wire, a removable junction box is standard;
- Further improves heat dissipation.
- High efficiency and high torque density design with high material utilization, small size and light weight.
- The inner rotor structure improves electromagnetic structure, result smooth low speed running and high overload capacity.
- Use shaft brake, with the advantage of compact structure, low braking noise and fast response time.

主机技术参数 (Parameter of Traction Machine)

额定电压 (Voltage) : AC380V
 悬挂比 (Roping) : 2: 1
 钢丝绳绕法 (Wrap) : 单绕 (Single)
 额定载重量 (Capacity) : 450kg~2000kg
 轿厢速度 (Speed) : 1.0m/s~2.5m/s
 防护等级 (Protection Grade) : IP41
 绝缘等级 (Ins. Class) : F
 曳引机极数(Traction machine pole): 20
 启动频次(次/小时, Stars per hour): 240
 工作制(Rating): S5-40%
 推荐提升高度(Height): ≤80m

制动器技术参数 (Parameter of Brake)

型号 (Model) : BLS
 绝缘等级 (Ins.Class) : F
 额定电压 (Voltage) : DC110V
 额定电流 (Current) :

载重(kg) Capacity	额定电流 Current
450kg~1275kg	1.46A × 2
1350kg~2000kg	2.2A × 2

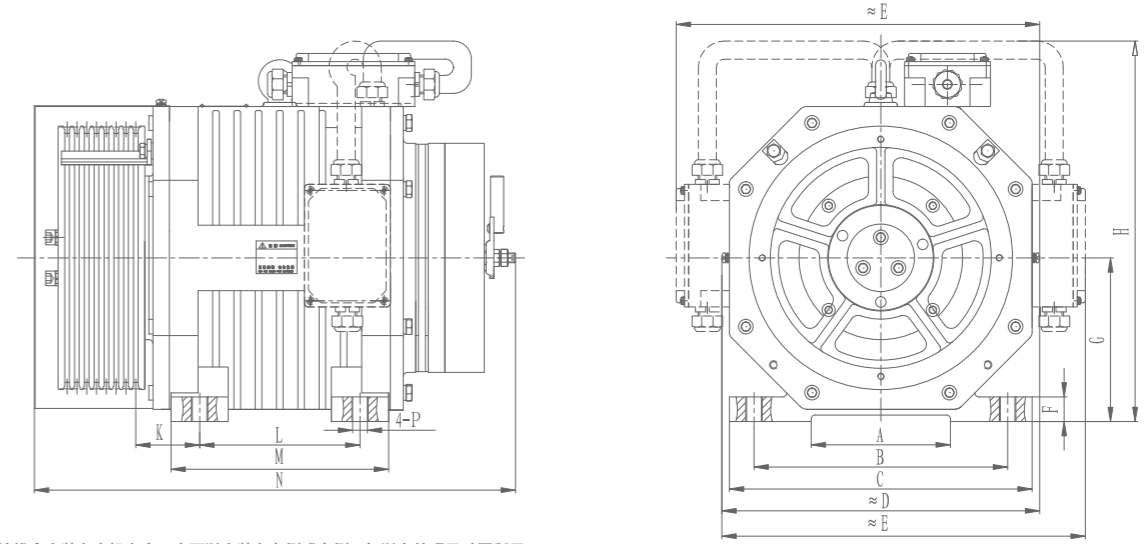

注: 本机主机接线盒安装在主机上方, 也可以安装在左侧或右侧, 如以上外观尺寸图所示。
 Remark: The machine junction box can be installed on the top or left or right side of the host, as shown in the above outline drawing.

外观尺寸图 | Outline drawing

WYT-L 无机房款 \ WYT-L Machine Roomless Version

系列 Series	型号 Model	载重 Capacity (kg)	轿厢速度 Speed (m/s)	曳引轮直径 Sheave (mm)	槽数 Num	绳径 (mm)	槽间距 Pitch (mm)	额定电流 Current (A)	额定转速 Motor Speed (rpm)	额定频率 Frequency (Hz)	额定功率 Power (kW)	额定转矩 Torque (Nm)	最大抽 负荷 Shaft Load (kg)	主机重量 Weight (kg)	安装尺寸 Dimension(mm)															
															A	B	C	D	E	F	G	H	K	L	M	N	P			
WYT-L	DN1.0AS	450	1.0	φ240	7	φ6	9	7.8	159	26.5	3	180	2000	≈200	150	270	320	356	403	25	170	410	70	190	244	515	M20			
	DN1.5AS		1.5					12.2	238	40	4.5																			
	DN1.6AS		1.6					12.5	254	42.3	4.8																			
	DN1.75AS		1.75					12.7	278	46.3	5.2																			
	DN1.0A	1.0	450	φ320	4	φ8	12	7.6	119	19.8	3	240	2000	≈200	150	270	320	356	403	25	170	410	70	190	244	515	M20			
	DN1.5A	1.5						12.2	178	29.7	4.5																			
	DN1.6A	1.6						12.5	190	31.7	4.8																			
	DN1.75A	1.75						12.7	208	34.7	5.2																			
	DN1.0BS	1.0	630	φ240	8	φ6	9	10.4	159	26.5	4	240	2000	≈200	150	270	320	356	403	25	170	410	70	190	244	515	M20			
	DN1.5BS	1.5						15.4	238	40	6																			
	DN1.6BS	1.6						15.7	254	42.3	6.4																			
	DN1.75BS	1.75						16.4	278	46.3	7																			
	DN1.0B	1.0	630	φ320	5	φ8	12	9.6	119	19.8	4	320	2000	≈200	150	270	320	356	403	25	170	410	70	190	244	515	M20			
	DN1.5B	1.5						15.6	178	29.7	6																			
	DN1.6B	1.6						16.0	190	31.7	6.4																			
	DN1.75B	1.75						16.5	208	34.7	7																			
	CN1.0CS	1.0	800	φ240	10	φ6	9	12.9	159	26.5	5.3	320	4000	≈270	170	310	370	390	445	30	200	465	78	196	266	588	M20			
	CN1.5CS	1.5						21.5	238	40	8																			
	CN1.6CS	1.6						21.8	254	42.3	8.5																			
	CN1.75CS	1.75						22.5	278	46.3	9.3																			
	CN2.0CS	2.0	800	φ320	6	φ8	12	25	318	53	10.7	430	4000	≈270	170	310	370	390	445	30	200	465	78	196	266	588	M20			
	CN1.0C	1.0						12.7	119	19.8	5.4																			
	CN1.5C	1.5						21.5	178	29.7	8																			
	CN1.6C	1.6						21.8	190	31.7	8.6																			
CN1.75C	1.75	1050	φ240	10	φ6	9	22.5	208	34.7	9.4	400	4000	≈270	170	310	370	390	445	30	200	465	78	196	266	588	M20				
CN2.0C	2.0						25	239	39.8	10.8																				
CN1.0DS	1.0						15.3	159	26.5	6.7																				
CN1.5DS	1.5						26	238	40	10																				
CN1.6DS	1.6	1050	φ320	7	φ8	12	26.4	254	42.3	10.6	530	4000	≈270	170	310	370	390	445	30	200	465	78	196	266	588	M20				
CN1.75DS	1.75						26.8	278	46.3	11.6																				
CN2.0DS	2.0						29.2	239	39.8	13.3																				
CN1.0E	1.0						16.7	119	19.8	7.2																				
CN1.5E	1.5	1150	φ320	8	φ8	12	27.4	178	29.7	10.8	580	4000	≈270	170	310	370	390	445	30	200	465	78	196	266	588	M20				
CN1.6E	1.6						27.8	190	31.7	11.5																				
CN1.75E	1.75						29.3	208	34.7	12.6																				
CN2.0E	2.0						31.9	239	39.8	14.5																				
CN1.0F	1.0	1275	φ320	8	φ8	12	18.1	119	19.8	7.9	630	4000	≈270	170	310	370	390	445	30	200	465	78	196	266	588	M20				
CN1.5F	1.5						29.6	178	29.7	11.7																				
CN1.6F	1.6						30.0	190	31.7	12.5																				
CN1.75F	1.75						31.8	208	34.7	13.7																				
CN2.0F	2.0	1350	φ400	8	φ10	16	34.7	239	39.8	15.8	880	4000	≈270	170	310	370	390	445	30	200	465	78	196	266	588	M20				
EN1.0G	1.0						19.5	96	16	8.8																				
EN1.5G	1.5						30.7	144	24	13.3																				
EN1.6G	1.6						31.2	153	26	14.1																				
EN1.75G	1.75	1600	φ400	8	φ10	16	33.7	168	28	15.4	1040	6500	≈800	245	415	495	515	605	50	280	638	133	250	370	848	M24				
EN2.0G	2.0						39.3	192	32	17.6																				
EN2.5G	2.5						47.2	240	40	22.1																				
EN1.0H	1.0						22.9	96	16	10.4																				
EN1.5H	1.5	2000	φ400	10	φ10	16	38	144	24	15.7	1310	6500	≈800	245	415	495	515	605	50	280	638	133	250	370	848	M24				
EN1.6H	1.6						39.3	153	26	16.6																				
EN1.75H	1.75						40.5	168	28	18.2																				
EN2.0H	2.0						46	192	32	20.8																				
EN2.5H	2.5	2000	φ400	10	φ10	16	57.5	240	40	26.1	1310	6500	≈800	245	415	495	515	605	50	280	638	133	250	370	848	M24				
EN1.0I	1.0						28.7	96	16	13.1																				
EN1.5I	1.5						48.4	144	24	19.8																				
EN1.6I	1.6						49.5	153	26	20.9																				
EN1.75I	1.75	2000	φ400	10	φ10	16	50.8	168	28	22.9	1310	6500	≈800	245	415	495	515	605	50	280	638	133	250	370	848	M24				
EN2.0I	2.0						57.6	192	32	26.2																				
EN2.5I	2.5						68.0	240	40	32.9																				

WYT-F 别墅梯款

WYT-F Villa Version

针对日益增长的家庭电梯市场，蓝光集团开发了 WYT-F 系列家庭曳引机，使用钢带作为传动介质，配合蓝光集团配套开发的 STD43 系列电梯专用钢带，使电梯舒适感更好，噪音更小。同时曳引机体积小，适合无机房设计，安装维护简单。

Due to increase needs of home (belt villa) elevator, Bluelight group develop WYT-F series belt drive PMS machine. The belt machine can work with Bluelight belt (STD 43) to achieve best lift comfort level with minimum operation noise. This series machine has small size suitable for MRL design and easy maintenance.



特点 (Features)

- 外壳采用铝合金材质，具有良好的散热性，体积小，重量轻；
- 主机采用轴刹制动器，结构紧凑，制动噪音低；
- 采用自密封轴承，免维护；
- 运行平稳，低速性能好。
- Machine is made of aluminum alloy material, with good heat dissipation, small size and light weight;
- Configured with shaft brake of low noise and compact structure;
- Adopt two blance full sealed bears, free maintain;
- Smooth running, excellent performance at low speed.

钢带技术参数 (Parameter of Belt)

型号 (Model) : SYLG_EB_43A

宽度 (Width) : 30 mm

厚度 (Thickness) : 3.3 mm

钢带破断拉力 (Breaking Force) : 43 kN

钢丝绳直径 (WireRope Diameter) : ϕ 1.98 mm

钢丝绳根数 (Rope Number) : 10根

外层包覆 (Outer Cover) : 热塑性聚氨酯 (Thermoplastic Polyurethane)

主机技术参数 (Parameter of Traction Machine)

额定电压 (Voltage) : AC380V/AC220V

悬挂比 (Roping) : 2: 1

钢丝绳绕法 (Wrap) : 单绕 (Single)

额定载重量 (Capacity) : 450kg

轮直径 (Wheel Diameter) : Φ 100

轿厢速度 (Speed) : 0.4m/s ~ 1.0m/s

防护等级 (Protection Grade) : IP41

绝缘等级 (Ins. Class) : F

曳引机极数(Traction machine pole): 20

启动频次(次/小时, Stars per hour): 150

工作制(Rating): S5-25%

推荐提升高度(Height): \leq 20m

制动器技术参数 (Parameter of Brake)

型号 (Model) : BLS

绝缘等级 (Ins.Class) : F

额定电压 (Voltage) : DC110V

额定电流 (Current) : 1.1A

WYT-F 系列 (2 轮分列式) \ WYT-F Series (2-Wheel Separated)

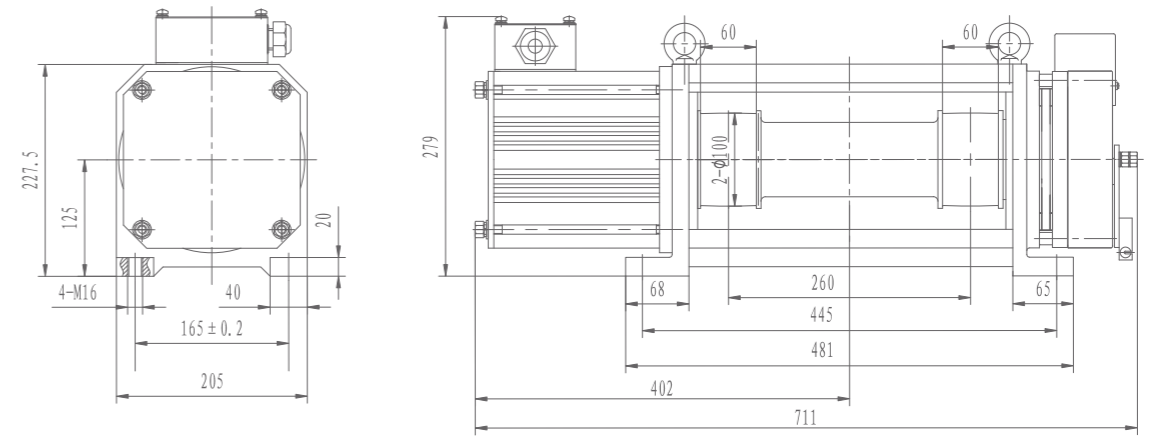

外观尺寸图 | Outline drawing

技术参数 (Technical parameters)

系列 Series	型号 Model	载重 Capacity (kg)	轿厢速度 Speed (m/s)	曳引轮直径 Sheave (mm)	槽数 Num	槽宽 Width (mm)	槽间距 Pitch (mm)	额定电压 Voltage (v)	额定电流 Current (A)	额定转速 Motor Speed (rpm)	额定频率 Frequency (Hz)	额定功率 Power (kW)	额定转矩 Torque (Nm)	最大轴负荷 Shaft Load (kg)	主机重量 Weight (kg)
WYT-F	E2V0.4B 100/260	450	0.4	ϕ 100	2	60	260	380	3.3	153	25.5	1.1	70	2000	~81
								220	5.7						
	E2V1.0B 100/260	1.0	380	6.4	382	63.7	2.8	70	2000	~81					
			220	11											

WYT-F 2 轮分列式钢带导向轮组件

WYT-F 2-Wheel Split Steel Belt Guide Wheel Assembly

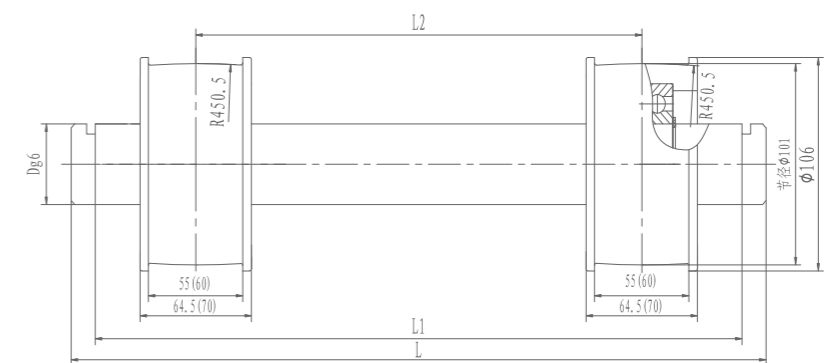

外观尺寸图 | Outline drawing

导轮参数 (Parameter of Guide Wheel)

组件型号 Model	轴长D Shaft Length D (mm)	轴长L Shaft Length L (mm)	轴槽尺寸 Shaft Groove Size (mm)	L1 (mm)	钢带数 Steel Strips	轮外径 Wheel Outer Diameter (mm)	轮槽宽 Wheel Groove Size (mm)	L2 (mm)	轮节径 Wheel Pitch Diameter (mm)	轴承 Bearing	适用别墅梯 Applicable To Villa Ladder	备注 Remarks
ZLF108/60-2-6207-405	35	405	6 X 8	377	2	108	60	260	100	6207-2RS	√	轴卡 (Shaft clamp)
ZLF106/55-2-6208-405	40	405	6 X 8	377	2	106	55	260	101	6208-2RS	√	轴卡 (Shaft clamp)

注: 通轴公差G6(-0.009~0.025);轮孔公差M7(-0.03~0); 轮/轴表面镀铬, 但不包括轴沟/槽及两端加工面。

Note: through shaft tolerance G6 (-0.009 ~ 0.025); Wheel hole tolerance M7 (-0.03 ~ 0); The wheel / shaft surface s plated with hard chromium, but does not include shaft groove / groove and machined surfaces at both ends.

WYT-F 系列 (2 轮并列式) \ WYT-F Series (2-Wheel Paralle)

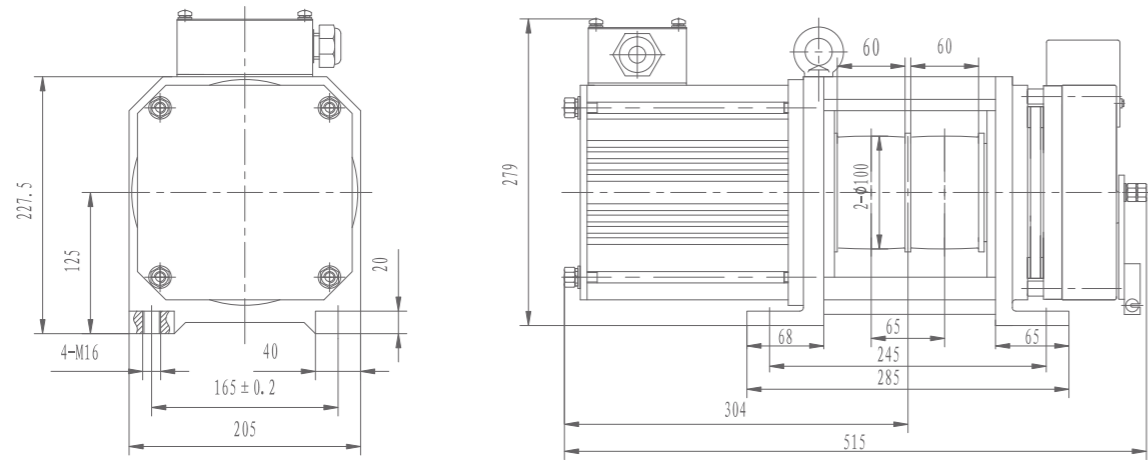

外观尺寸图 | Outline drawing

技术参数 (Technical parameters)

系列 Series	型号 Model	载重 Capacity (kg)	轿厢速度 Speed (m/s)	曳引轮直径 Sheave (mm)	槽数 Num	槽宽 Width (mm)	槽间距 Pitch (mm)	额定电压 Voltage (v)	额定电流 Current (A)	额定转速 Motor Speed (rpm)	额定频率 Frequency (Hz)	额定功率 Power (kW)	额定转矩 Torque (Nm)	最大轴负荷 Shaft Load (kg)	主机重量 Weight (kg)
WYT-F	E2V0.4B 100/65	450	0.4	φ100	2	60	65	380	3.3	153	25.5	1.1	70	2000	≈68
								220	5.7	382	63.7	2.8			
	E2V1.0B 100/65		1.0					380	6.4						
								220	11						

WYT-F 2 轮并列式钢带导向轮组件 WYT-F 2-Wheel Parallel Steel Belt Guide Wheel Assembly

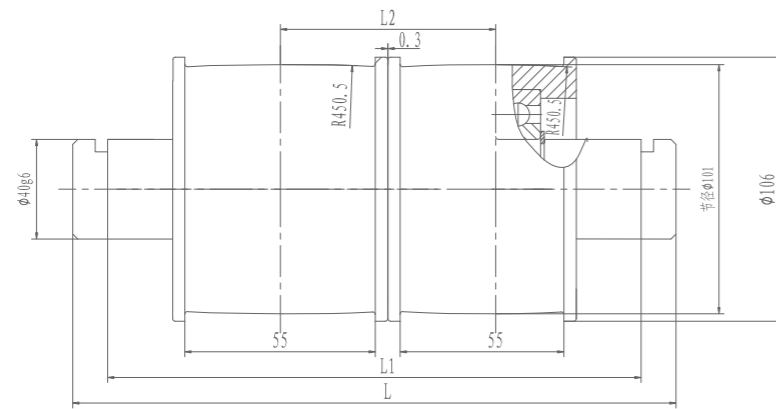

外观尺寸图 | Outline drawing

导轮参数 (Parameter of Guide Wheel)

组件型号 Model	轴长D Shaft Length D (mm)	轴长L Shaft Length L (mm)	轴槽尺寸 Shaft Groove Size (mm)	L1 (mm)	钢带数 Steel Strips	轮外径 Wheel Outer Diameter (mm)	轮槽宽 Wheel Groove Size (mm)	L2 (mm)	轮节径 Wheel Pitch Diameter (mm)	轴承 Bearing	适用别墅梯 Applicable To Villa Ladder	备注 Remarks
ZL106/55-2-6208-210	40	210	6 X 8	182	2	106	55	65	101	6208-2RS	√	轴卡X4 (Shaft clamp)

注：通轴公差G6(-0.009~0.025);轮孔公差M7(-0.03~0); 轮/轴表面镀铬，但不包括轴沟/槽及两端加工面。

Note: through shaft tolerance G6 (- 0.009 ~ 0.025); Wheel hole tolerance M7 (- 0.03 ~ 0); The wheel / shaft surface s plated with hard chromium, but does not include shaft groove / groove and machined surfaces at both ends.

钢带绳头组合 (通用) Belt Lock (General)

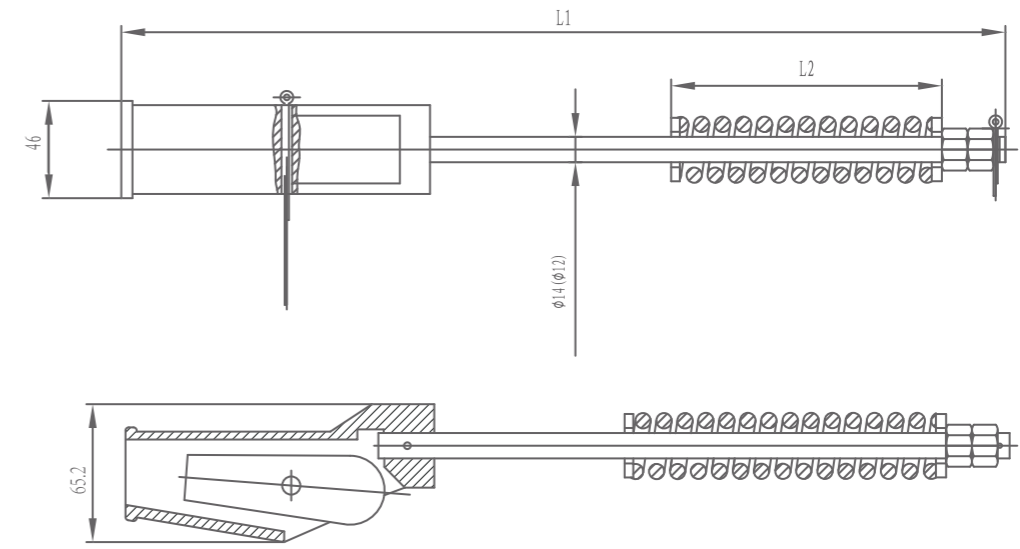

外观尺寸图 | Outline drawing

钢带绳头组合参数 (Parameter of Belt Lock)

型号 Model	适配曳引带宽度 Suitable traction belt width	最大提升高度 Max lifting height	L1 (mm)	L2 (mm)	备注 Note
GD-ST-30-12A	30mm	H≤12m	240	65	别墅梯 / 胶墩款
GD-ST-30-12B	30mm	H≤12m	320	128	别墅梯
GD-ST-30-12	30mm	H≤12m	393	128	客 / 别墅梯
GD-ST-30-20	30mm	12m≤H≤20m	418	128	客 / 货梯

大载重系列 WYT - V / V1S / U

HEAVY LOAD SERIES

WYT-V 系列是我公司新推出的大载重高速高性能无齿轮永磁同步曳引机，针对高层大载重厂房用梯特点采用双支撑结构，结构更合理可靠，性能更优异，具有国际领先水平。

WYT-V series PMS machine is developed for high rise factory plant cargo lift, it uses latest Permanent magnetic motor technology, optimised electromagnetic & mechanical design with excellent operation performance.

WYT-V



主机技术参数 (Parameter of Traction Machine)

- 额定电压 (Voltage) : AC380V
- 悬挂比 (Roping) : 1: 1
- 钢丝绳绕法 (Wrap) : 单绕 (Single)
- 额定载重量 (Capacity) : 1000kg~1500kg
- 轿厢速度 (Speed) : 1.0m/s~4.0m/s
- 防护等级 (Protection Grade) : IP41
- 绝缘等级 (Ins. Class) : F
- 曳引机极数(Traction machine pole): 30
- 启动频次(次/小时, Stars per hour): 240
- 工作制(Rating): S5-40%
- 推荐提升高度(Height): ≤120m

制动器技术参数 (Parameter of Brake)

- 型号 (Model) : BLB
- 绝缘等级 (Ins.Class) : F
- 额定电压 (Voltage) : DC110V
- 额定电流 (Current) : 1.98A

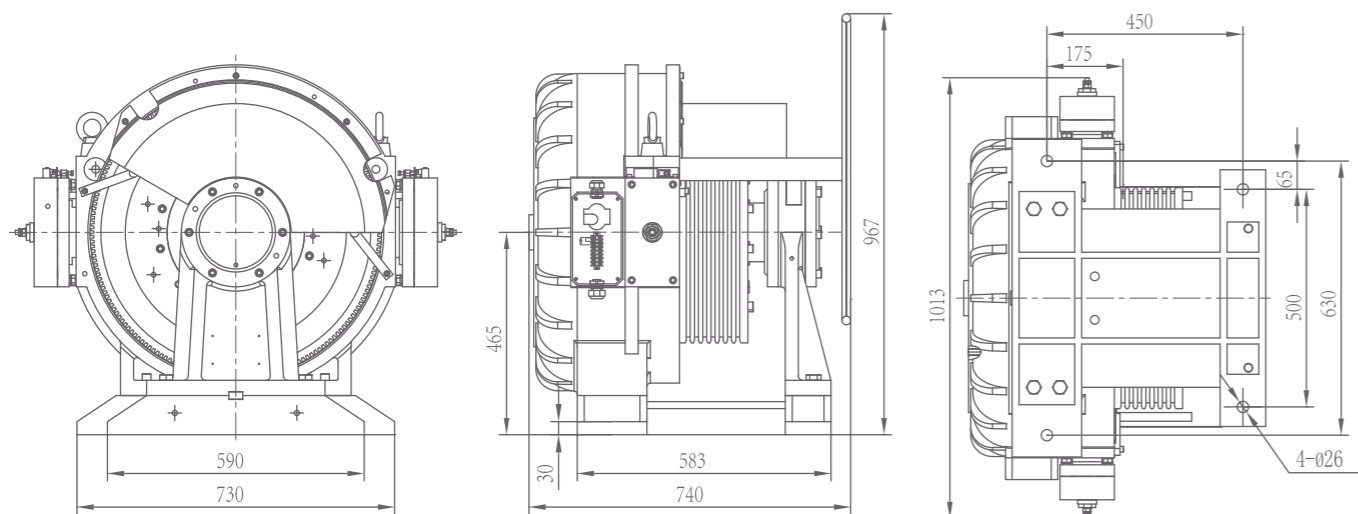

外观尺寸图 | Outline drawing

WYT-V 大载重 (1:1) \ WYT-V Heavy Load (1:1)

系列 Series	型号 Model	载重 Capacity (kg)	轿厢速度 Speed (m/s)	曳引轮直径 Sheave (mm)	槽数 Num	绳径 (mm)	槽间距 Pitch (mm)	额定电流 Current (A)	额定转速 Motor Speed (rpm)	额定频率 Frequency (Hz)	额定功率 Power (kW)	额定转矩 Torque (Nm)	能效等级 Energy Efficiency Grade	最大轴负荷 Shaft Load (kg)	主机重量 Weight (kg)
WYT-V	1.0BS48	1000	1.0	φ480	10	φ10	16	14.8	40	9.95	6.6	1570	2	10000	~960
	1.5BS48		1.5					21.8	60	15	9.9				
	1.75BS48		1.75					25.3	70	17.5	11.5				
	2.0BS48		2.0					28.7	80	19.9	13.1				
	2.5BS48		2.5					37	100	25	16.4				
	3.0BS48		3.0					44.2	119	29.8	19.6				
	4.0BS48	4.0	59	159	39.8	26.1									
	1.0BS50	1000	1.0	φ500	7	φ12	19	14.8	38	9.5	6.6	1640			
	1.5BS50		1.5					21.8	57	14.3	9.9				
	1.75BS50		1.75					25.3	67	16.7	11.5				
	2.0BS50		2.0					28.7	76	19	13.1				
	2.5BS50		2.5					37	96	24	16.4				
	3.0BS50		3.0					44.2	115	28.7	19.7				
	4.0BS50	4.0	59	153	38.2	26.3									
	1.0BCS48	1150	1.0	φ480	10	φ10	16	17	40	9.95	7.5	1800			
	1.5BCS48		1.5					25.2	60	15	11.3				
	1.75BCS48		1.75					29.4	70	17.5	13.2				
	2.0BCS48		2.0					33.3	80	19.9	15				
	2.5BCS48		2.5					41.8	100	25	18.8				
	3.0BCS48		3.0					50	119	29.8	22.4				
	4.0BCS48	4.0	66.7	159	39.8	30									
	1.0BCS50	1150	1.0	φ500	7	φ12	19	17	38	9.5	7.5	1880			
	1.5BCS50		1.5					25.2	57	14.3	11.3				
	1.75BCS50		1.75					29.4	67	16.7	13.2				
2.0BCS50	2.0		33.3					76	19	15					
2.5BCS50	2.5		41.8					96	24	18.8					
3.0BCS50	3.0		50					115	28.7	22.6					
4.0BCS50	4.0	66.7	153	38.2	30.1										
1.0CS48	1250	1.0	φ480	10	φ10	16	19	40	9.95	8	1940				
1.5CS48		1.5					27.8	60	15	12.1					
1.75CS48		1.75					32	70	17.5	14.2					
2.0CS48		2.0					36.6	80	19.9	16.1					
2.5CS48		2.5					45.5	100	25	20.3					
3.0CS48		3.0					54.8	119	29.8	24.2					
4.0CS48	4.0	73	159	39.8	32.3										
1.0CS50	1250	1.0	φ500	7	φ12	19	19	38	9.5	8	2020				
1.5CS50		1.5					27.8	57	14.3	12.1					
1.75CS50		1.75					32	67	16.7	14.2					
2.0CS50		2.0					36.6	76	19	16.1					
2.5CS50		2.5					45.5	96	24	20.3					
3.0CS50		3.0					54.8	115	28.7	24.3					
4.0CS50	4.0	73	153	38.2	32.4										
1.0DES48	1500	1.0	φ480	9	φ12	18	22.8	40	9.95	9.6	2286				
1.5DES48		1.5					32.7	60	15	14.4					
1.75DES48		1.75					38.2	70	17.5	16.8					
2.0DES48		2.0					43.6	80	19.9	19.2					
2.5DES48		2.5					54.3	100	25	23.9					
3.0DES48		3.0					64	119	29.8	28.5					
4.0DES48	4.0	85.8	159	39.8	38.1										

标准系列
Standard Series

WYT-T
WYT-TS
WYT-TF
WYT-TD
WYT-TE

静音系列
Comfortable Series

WYT-L
WYT-F

大载重系列
Heavy Load Series

WYT-V
WYT-V1S
WYT-U

高速系列
High Speed Series

WYT-H
WYT-Y

绳槽参数
The Parameter List of Groove

钢带
Hoisting Belt

SYLG-E

WYT-V1S



主机技术参数 (Parameter of Traction Machine)

额定电压 (Voltage) : AC380V
 悬挂比 (Roping) : 1: 1
 钢丝绳绕法 (Wrap) : 单绕 (Single)
 额定载重量 (Capacity) : 1500kg~2500kg
 轿厢速度 (Speed) : 1.0m/s~4.0m/s
 防护等级 (Protection Grade) : IP41
 绝缘等级 (Ins. Class) : F
 曳引机极数 (Traction machine pole) : 30
 启动频次 (次/小时, Stars per hour) : 240
 工作制 (Rating) : S5-40%

特点 (Features)

- 双支撑结构, 结构更合理可靠, 性能更优异;
- 高负荷, 高效率, 高转矩密度;
- 主机运行平稳, 振动小;
- 主机散热良好, 温升低;
- Double support structure, reliable structure, better performance;
- High load, high efficiency, high torque density;
- The machine runs smoothly, low vibration;
- The heat dissipation design of the machine is good, and the low temperature rises;

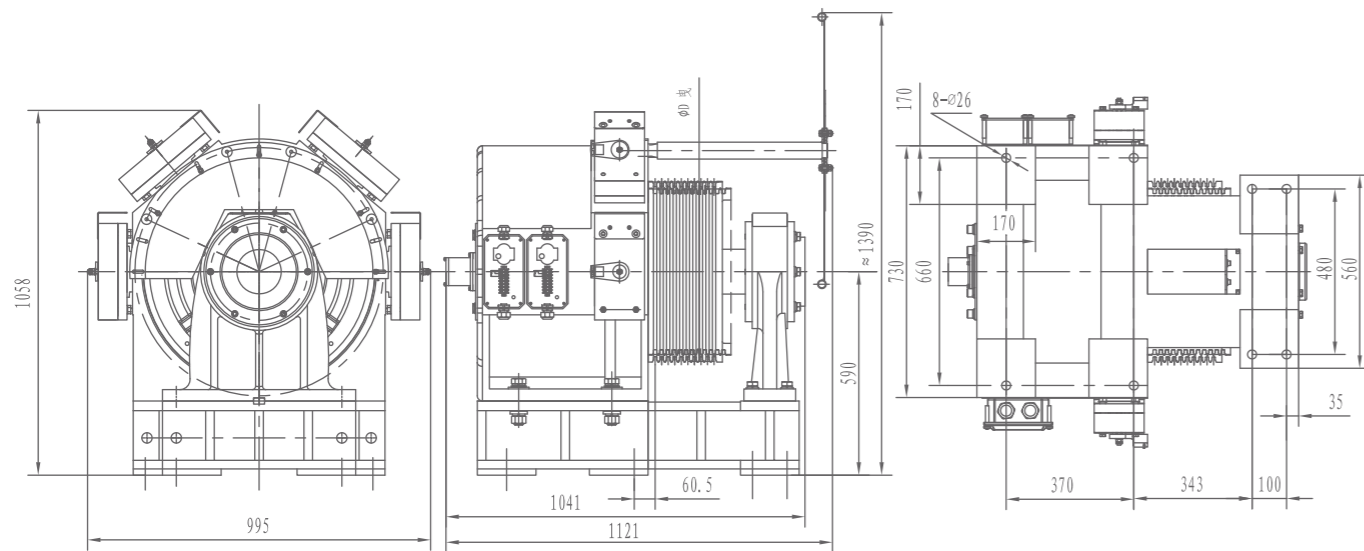

外观尺寸图 | Outline drawing

制动器技术参数 (Parameter of Brake)

型号 (Model) : BLB 绝缘等级 (Ins. Class) : F 额定电压 (Voltage) : DC110V
 额定电流 (Current) : 1.98A

WYT-V1S 大载重 (1:1) \ WYT-V1S Heavy Load (1:1)

系列 Series	型号 Model	载重 Capacity (kg)	轿厢速度 Speed (m/s)	曳引轮直径 Sheave (mm)	槽数 Num	绳径 (mm)	槽间距 Pitch (mm)	额定电流 Current (A)	额定转速 Motor Speed (rpm)	额定频率 Frequency (Hz)	额定功率 Power (kW)	额定转矩 Torque (Nm)	最大轴负荷 Shaft Load (kg)	主机重量 Weight (kg)
WYT-V1S	C1.0DE	1500	1.0	φ480	12	φ12	18	22.8	40	9.95	9.6	2286	15000	≈2200
	C1.75DE		1.75					38.2	70	17.5	16.8			
	C2.0DE		2.0					43.6	80	19.9	19.2			
	C3.0DE		3.0					64	119	29.8	28.5			
	C4.0DE		4.0					85.8	159	39.8	38.1			
	C1.0DEL		1.0					22.8	37	9.3	9.6			
	C1.75DEL	1.75	38.2	64	16	16.6								
	C2.0DEL	2.0	43.6	73	18.3	18.9	2476							
	C3.0DEL	3.0	64	110	27.5	28.5								
	C4.0DEL	4.0	85.8	147	36.7	38.1								
	C1.0F	2000	1.0	φ480	12	φ12	18	26.6	40	9.95	12.1	2900		
	C1.75F		1.75					46.5	70	17.5	21.3			
C2.0F	2.0		53.0					80	19.9	24.3				
C3.0F	3.0		79.0					119	29.8	36.1				
C4.0F	4.0		105.3					159	39.8	48.3				
C1.0FL	1.0		26.6					37	9.3	12.1				
C1.75FL	1.75	46.5	64	16	21.0									
C2.0FL	2.0	53.0	73	18.3	24.0	3140								
C3.0FL	3.0	79.0	110	27.5	36.2									
C4.0FL	4.0	105.3	147	36.7	48.3									
C1.0G	2500	1.0	φ480	12	φ12	18	32.8	40	9.95	15.1	3600			
C1.75G		1.75					57.2	70	17.5	26.4				
C2.0G		2.0					65.7	80	19.9	30.2				
C3.0G		3.0					98.3	119	29.8	44.9				
C4.0G		4.0					130.5	159	39.8	59.9				
C1.0GL		1.0					32.8	37	9.3	15.1				
C1.75GL	1.75	57.2	64	16	26.1									
C2.0GL	2.0	65.7	73	18.3	29.8	3900								
C3.0GL	3.0	98.3	110	27.5	44.9									
C4.0GL	4.0	130.5	147	36.7	60.0									

此系列主机推荐槽型: 单绕V型槽
Recommended single groove V

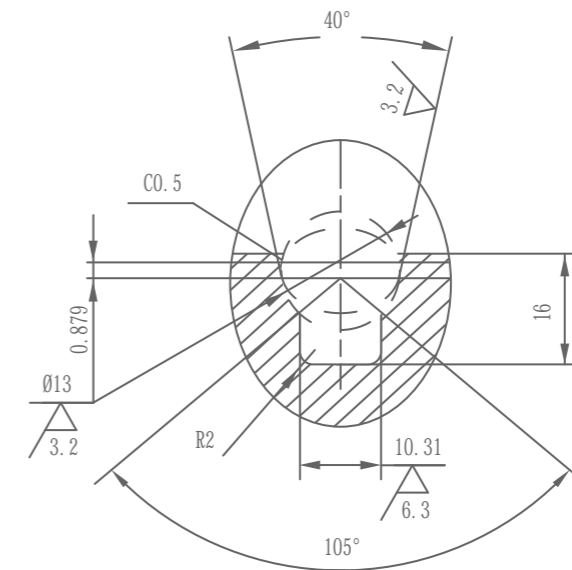

外观尺寸图 | Outline drawing

WYT-U 永磁同步曳引机

WYT-U PM Traction Machine

WYT-U系列产品是客户专门设计的大扭矩、大载重曳引机，广泛应用于高层建筑中的观光梯、客梯、货梯，医院中的病床梯等。

WYT-U series products are designed with large torque and heavy load capacity. It is widely used in high-rise buildings elevator applications such as panorama elevator, passenger & cargo elevator, hospital bed elevator and else.

主机技术参数 (Parameter of Traction Machine)

- 额定电压 (Voltage) : AC380V
- 悬挂比 (Roping) : 2: 1
- 钢丝绳绕法 (Wrap) : 单绕 (Single)
- 额定载重量 (Capacity) : 1350kg~2000kg
- 轿厢速度 (Speed) : 1.0m/s~2.5m/s
- 防护等级 (Protection Grade) : IP41
- 绝缘等级 (Ins. Class) : F
- 曳引机极数(Traction machine pole): 30
- 启动频次(次/小时, Stars per hour): 240
- 工作制(Rating): S5-40%
- 推荐提升高度(Elevator Height): ≤120m

制动器技术参数 (Parameter of Brake)

- 型号 (Model) : BLB
- 绝缘等级 (Ins.Class) : F
- 额定电压 (Voltage) : DC110V
- 额定电流 (Current) :

系列 Series	梯速(m/s) Speed	载重代号 Capacity code	额定电流 Current
WYT-U	1.0~2.5	DS, ES(1350kg~1600kg)	1.3A
		FS(2000kg)	1.6A

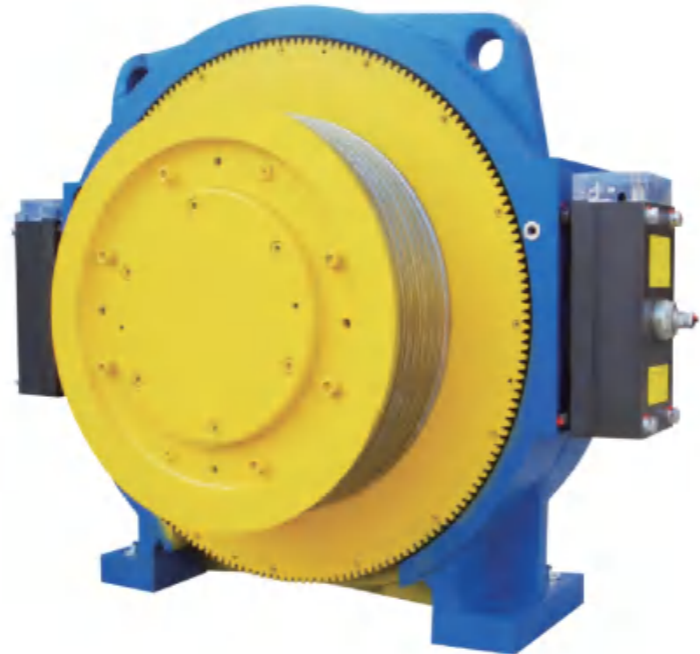

特点 (Features)

- ◎ 低速运行平稳，效率高，转矩大；
- ◎ 采用高性能的永磁材料和完善的磁路结构，使温升和噪音都远远低于行业标准；
- ◎ 曳引机采用过热保护装置，设计完善，可靠性高；
- ◎ 采用BLB块式制动器，结构简单，制动安全可靠。
- ◎ Low-speed operation is smooth, high efficiency, large torque;
- ◎ Use high performance permanent magnetic materials and improve the magnetic circuit structure, so that the temperature rise and noise are much lower than industry standard.
- ◎ Traction machine use overheating protection device, with extra safety & reliability;
- ◎ Use block type armless brake, simple structure with fast response time and high reliability.

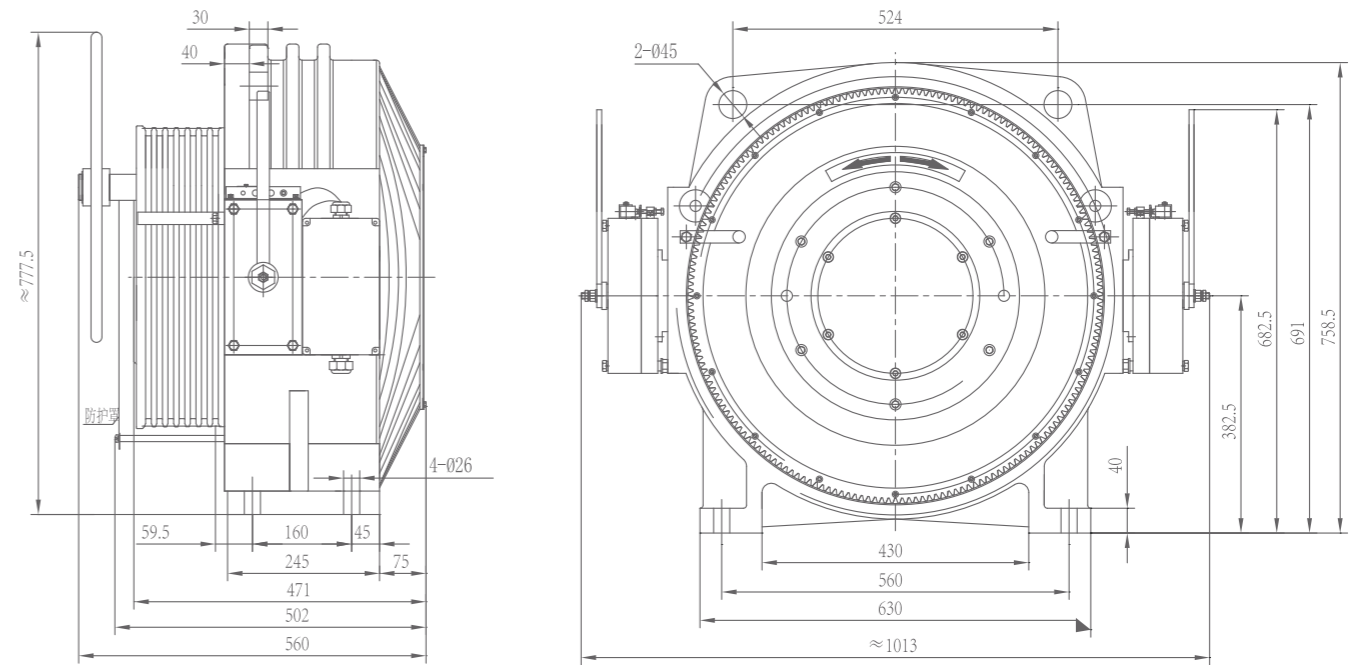

外观尺寸图 | Outline drawing

WYT-U 外转子系列 \ WYT-U Outer Rotor Series

系列 Series	型号 Model	载重 Capacity (kg)	轿厢速度 Speed (m/s)	曳引轮直径 Sheave (mm)	槽数 Num	绳径 (mm)	槽间距 Pitch (mm)	额定电流 Current (A)	额定转速 Motor Speed (rpm)	额定频率 Frequency (Hz)	额定功率 Power (kW)	额定转矩 Torque (Nm)	最大轴负荷 Shaft Load (kg)	主机重量 Weight (kg)
WYT-U	1.0DS	1350	1.0	φ480	7	φ12	18	19.5	80	19.9	8.8	1055	7000	≈800
	1.75DS		1.75					33.7	139	34.8	15.4			
	2.0DS		2.0					39.3	159	39.8	17.6			
	2.5DS		2.5					47.2	199	49.7	22			
	1.0ES	1600	1.0	φ480	7	φ12	18	22.9	80	19.9	10.4	1250	7000	≈800
	1.75ES		1.75					40.5	139	34.8	18.2			
	2.0ES		2.0					46	159	39.8	20.8			
	2.5ES		2.5					57.5	199	49.7	26			
	1.0FS	2000	1.0	φ480	7	φ12	18	28.7	80	19.9	13.1	1570	7000	≈800
	1.75FS		1.75					50.8	139	34.8	22.9			
	2.0FS		2.0					57.6	159	39.8	26.2			
	2.5FS		2.5					71.9	199	49.7	32.7			

高速系列 WYT-H / Y HIGH SPEED SERIES

WYT-H 超高速款 WYT-H Ultra-high Speed Version

WYT-H系列主机是我公司推出的高性能大转矩超高速无齿轮永磁同步曳引机，适合超高层建筑电梯使用。经过不断的电磁及机械结构的优化，主机性能达到国际先进水平。

WYT-H series ultra-high speed PM gearless traction machine is developed by Bluelight in 2012 to target skyscrapers with ultra-high speed elevator (up to 8m/s).



主机技术参数 (Parameter of Traction Machine)

- 额定电压 (Voltage) : AC380V
- 悬挂比 (Roping) : 1: 1
- 钢丝绳绕法 (Wrap) : 复绕 (Double)
- 额定载重量 (Capacity) : 1600kg
- 轿厢速度 (Speed) : 5m/s ~ 8m/s
- 防护等级 (Protection Grade) : IP41
- 绝缘等级 (Ins. Class) : H
- 曳引机极数 (Traction machine pole): 30
- 启动频次(次/小时, Stars per hour): 240
- 工作制(Rating): S5-40%
- 推荐提升高度(Elevator Height): ≤360m

制动器技术参数 (Parameter of Brake)

- 型号 (Model) : EC-4026EF-100
- 绝缘等级 (Ins. Class) : F
- 额定电压 (Voltage) : DC90/40V
- 额定电流 (Current) : 4.7/2.1A

特点 (Features)

- ◎ 超大轴负荷设计,超高速设计;
- ◎ 优化的绕组使曳引机振动小,噪音低,损耗分布合理,精细的风冷散热设计,温升低;
- ◎ 原装进口碟刹制动器,制动系统安全可靠;

- ◎ Extra high shaft load design, suitable for ultra-high speed operation;
- ◎ Optimized winding design, less harmonic content, loss distribution optimization, fan cooling system with low temperature rise;
- ◎ Use SUNTES disk brake system, high reliability.

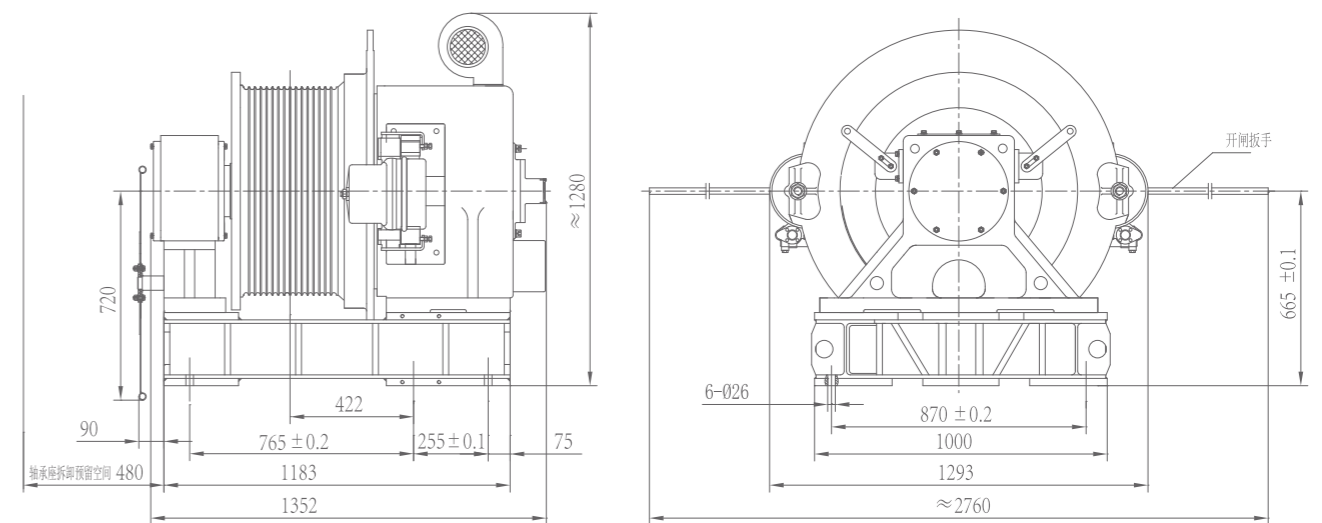

外观尺寸图 | Outline drawing

WYT-H 超高速款 \ WYT-H Ultra-high Speed Version

系列 Series	型号 Model	载重 Capacity (kg)	轿厢速度 Speed (m/s)	曳引轮直径 Sheave (mm)	槽数 Num	绳径 (mm)	槽间距 Pitch (mm)	额定电流 Current (A)	额定转速 Motor Speed (rpm)	额定频率 Frequency (Hz)	额定功率 Power (kW)	额定转矩 Torque (Nm)	最大轴负荷 Shaft Load (kg)	主机重量 Weight (kg)
WYT-H	5.0E1	1600	5.0	φ 710	16	φ 16	20	111.4	134	33.6	51	3626	35000	~3500
	6.0E1		6.0					135.3	161	40.3	61.2			
	7.0E1		7.0					158	188	47.1	71.5			
	8.0E1		8.0					172.7	215	53.8	81.7			

WYT-Y 单/复绕款

WYT-Y SINGLE / DOUBLE WRAP VERSION



WYT-Y 系列产品为高速 (4m/s)、大载重电梯开发, 是我司最早推出的内转子无齿轮永磁同步曳引机, 经过长期的应用及技术优化, 已发展为第二代产品。主机结构可靠, 轴负荷大, 适合载重量大的高层建筑应用。

WYT-Y series inner rotor type PM gearless traction machine is developed by Bluelight in 2004 for high speed (up to 4m/s) & high capacity (up to 2000kg) elevator. After long time of improvement & optimization, this series has development second version (MK II).

主机技术参数 (Parameter of Traction Machine)

- 额定电压 (Voltage): AC380V
- 悬挂比 (Roping): 2: 1
- 钢丝绳绕法 (Wrap): 单绕 (Single) /复绕 (Double)
- 额定载重量 (Capacity): 800kg ~ 2000kg
- 轿厢速度 (Speed): 1.0m/s ~ 4.0m/s
- 防护等级 (Protection Grade): IP41
- 绝缘等级 (Ins. Class): F
- 曳引机极数(Traction machine pole): 20
- 启动频次(次/小时, Stars per hour): 240
- 工作制(Rating): S5-40%
- 推荐提升高度(Height): ≤ 180m

制动器技术参数 (Parameter of Brake)

- 型号 (Model): DZE
- 绝缘等级 (Ins.Class): F
- 额定电压 (Voltage): AC220/110V
- 额定电流 (Current): 5.6/2.8A

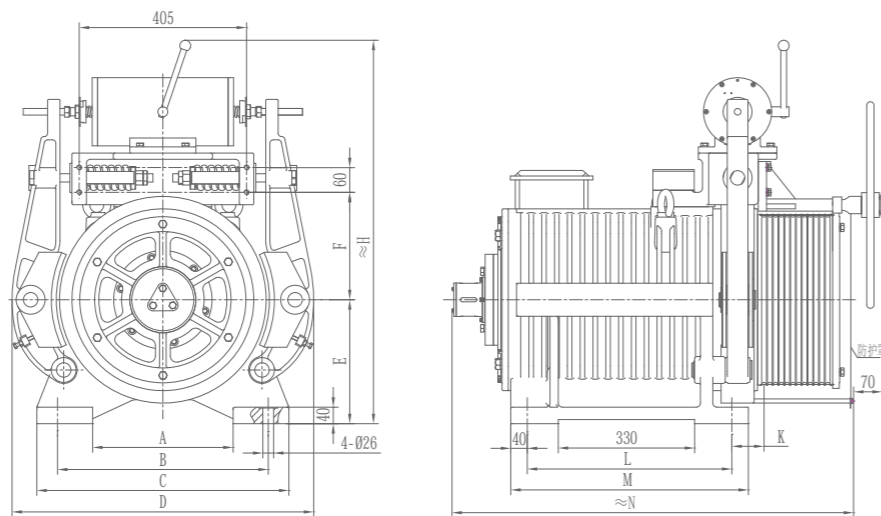

外观尺寸图 | Outline drawing

特点 (Features)

- ◎ 大轴负荷设计, 机械结构简洁可靠;
- ◎ 过载能力强, 低速性好, 在低速时可以平稳输出大扭矩;
- ◎ 轿厢速度范围宽、载重量覆盖广;
- ◎ 温升低, 效率高, 转矩大, 噪音低;
- ◎ 有单绕和复绕两种形式。
- ◎ Designed with large shaft load, simple and reliable mechanical structure;
- ◎ Excellent overload ability and low-speed performance.
- ◎ Wide range of car speed and capacity;
- ◎ Low temperature rise, high efficiency, large torque & low noise;
- ◎ Machine sheave can support single wrap and double wrap.

WYT-Y 内转子系列 (单绕系列) \ WYT-Y Inner Rotor Series (Single Wrap)

系列 Series	型号 Model	载重 Capacity (kg)	轿厢速度 Speed (m/s)	曳引轮直径 Sheave (mm)	槽数 Num	绳径 (mm)	槽间距 Pitch (mm)	额定电流 Current (A)	额定转速 Motor Speed (rpm)	额定频率 Frequency (Hz)	额定功率 Power (kW)	额定转矩 Torque (Nm)	最大轴负荷 Shaft Load (kg)	主机重量 Weight (kg)	安装尺寸 Dimension(mm)										
															A	B	C	D	E	F	H	K	L	M	N
WYT-Y	1.0A3	800	1.0	φ410	5	φ10	16	14	94	15.7	5.7	580	8000	≈850	340	510	610	730	300	260	960	78	380	460	820
	1.6A3		1.6					20.8	150	25	9.1														
	1.75A3		1.75					22.9	163	27.2	9.9														
	2.0A3		2.0					25.5	186	31	11.3														
	2.5A3		2.5					31.5	234	39	14.1														
	3.0A3		3.0					37.3	239	39.84	17														
	4.0A3	4.0	49.1	318	53	22.6																			
	1.0B3	1000	1.0	φ410	6	φ10	16	16.1	94	15.7	6.7	682													
	1.6B3		1.6					24.5	150	25	10.7														
	1.75B3		1.75					26.3	163	27.2	11.7														
	2.0B3		2.0					29.6	186	31	13.3														
	2.5B3		2.5					37.5	234	39	16.7														
	3.0B3		3.0					44.4	239	39.84	20														
	4.0B3	4.0	58.6	318	53	26.7																			
	1.0BC3	1150	1.0	φ410	7	φ10	16	19.4	94	15.7	8	810													
	1.6BC3		1.6					29.6	150	25	12.7														
	1.75BC3		1.75					32.2	163	27.2	13.8														
	2.0BC3		2.0					35.5	186	31	15.8														
	2.5BC3		2.5					43.6	234	39	19.8														
	3.0BC3		3.0					53.2	239	39.84	23.7														
	4.0BC3	4.0	70.2	318	53	31.6																			
	1.0C3	1275	1.0	φ410	7	φ10	16	20.1	94	15.7	8.6	868													
	1.6C3		1.6					30.6	150	25	13.6														
	1.75C3		1.75					33.6	163	27.2	14.8														
2.0C3	2.0		38					186	31	17															
2.5C3	2.5		47.1					234	39	21.2															
3.0C3	3.0		57.2					239	39.84	25.5															
4.0C3	4.0	76.5	318	53	34																				
1.0D3	1350	1.0	φ410	8	φ10	16	22	94	15.7	9.4	950														
1.6D3		1.6					33.5	150	25	14.9															
1.75D3		1.75					36.7	163	27.2	16.2															
2.0D3		2.0					41	186	31	18.5															
2.5D3		2.5					51.4	234	39	23.3															
3.0D3		3.0					62.3	239	39.84	27.8															
4.0D3	4.0	83.2	318	53	37																				
1.0E3	1600	1.0	φ410	9	φ10	16	25.2	94	15.7	11	1120														
1.6E3		1.6					39	150	25	17.6															
1.75E3		1.75					42.2	163	27.2	19.1															
2.0E3		2.0					48.2	186	31	21.9															
2.5E3		2.5					60	234	39	27.4															
3.0E3		3.0					74.6	239	39.84	33.3															
4.0E3	4.0	99.6	318	53	44.3																				
1.0EF3	1800	1.0	φ480	7	φ12	18	29.7	80	13.34	12.5	1330														
1.6EF3		1.6					45.8	127	21.2	19.8															
1.75EF3		1.75					49.6	139	23.2	21.7															
2.0EF3		2.0					55.8	159	26.5	24.8															
2.5EF3		2.5					71.5	199	33.2	31															
3.0EF3		3.0					85.2	239	39.84	37.3															
4.0EF3	4.0	112	318	53	49.6																				
1.0F3	2000	1.0	φ480	8	φ12	18	34	80	13.34	13.8	1650														
1.6F3		1.6					53	127	21.2	22															
1.75F3		1.75					54.9	139	23.2	24															
2.0F3		2.0					63.5	159	26.5	27.5															
2.5F3		2.5					80	199	33.2	34.4															
3.0F3		3.0					92	239	39.84	41.3															
4.0F3	4.0	123	318	53	54.9																				

WYT-Y 内转子系列 (复绕系列) \ WYT-Y Inner Rotor Series (Double Wrap)

系列 Series	型号 Model	载重 Capacity (kg)	轿厢速度 Speed (m/s)	曳引轮直径 Sheave (mm)	槽数 Num	绳径 (mm)	槽间距 Pitch (mm)	额定电流 Current (A)	额定转速 Motor Speed (rpm)	额定频率 Frequency (Hz)	额定功率 Power (kW)	额定转矩 Torque (Nm)	最大轴负荷 Shaft Load (kg)	主机重量 Weight (kg)	安装尺寸 Dimension(mm)													
															A	B	C	D	E	F	H	K	L	M	N			
WYT-Y	1.0A2	800	1.0	φ410	8	φ10	14	14	94	15.7	5.7	580	10000	≈850	340	510	610	730	300	260	960	78	495	575	970			
	1.6A2		1.6					20.8	150	25	9.1																	
	1.75A2		1.75					22.9	163	27.2	9.9																	
	2.0A2		2.0					25.5	186	31	11.3																	
	2.5A2		2.5					31.5	234	39	14.1																	
	3.0A2		3.0					37.3	239	39.84	17																	
	4.0A2	4.0	49.1	318	53	22.6																						
	1.0B2	1000	1.0	φ410	10	φ10	14	16.1	94	15.7	6.7	682																
	1.6B2		1.6					24.5	150	25	10.7																	
	1.75B2		1.75					26.3	163	27.2	11.7																	
	2.0B2		2.0					29.6	186	31	13.3																	
	2.5B2		2.5					37.5	234	39	16.7																	
	3.0B2		3.0					44.4	239	39.84	20																	
	4.0B2	4.0	58.6	318	53	26.7																						
	1.0C2	1275	1.0	φ480	10	φ12	15	22.4	80	13.34	8.5	1020																
	1.6C2		1.6					33.6	127	21.2	13.6																	
	1.75C2		1.75					36.5	139	23.2	14.8																	
	2.0C2		2.0					41.5	159	26.5	17																	
	2.5C2		2.5					51.4	199	33.2	21.3																	
	3.0C2		3.0					60.3	239	39.84	25.5																	
	4.0C2	4.0	79.5	318	53	34																						
	1.0D2	1350	1.0	φ480	10	φ12	15	25	80	13.34	9.5	1140																
	1.6D2		1.6					37.6	127	21.2	15.2																	
	1.75D2		1.75					40.8	139	23.2	16.6																	
	2.0D2		2.0					46.4	159	26.5	19																	
	2.5D2		2.5					57.4	199	33.2	23.8																	
	3.0D2		3.0					67.4	239	39.84	28.5																	
	4.0D2	4.0	89	318	53	38																						
	1.0E2	1600	1.0	φ480	10	φ12	15	27	80	13.34	11.1	1330																
	1.6E2		1.6					41	127	21.2	17.7																	
	1.75E2		1.75					45.8	139	23.2	19.4																	
	2.0E2		2.0					51	159	26.5	22.2																	
	2.5E2		2.5					63.8	199	33.2	27.7																	
	3.0E2		3.0					74.6	239	39.84	33.3																	
	4.0E2	4.0	99.6	318	53	44.3																						
	1.0EF2	1800	1.0	φ480	12	φ12	15	29.7	80	13.34	12.5	1490																
	1.6EF2		1.6					45.8	127	21.2	19.8																	
	1.75EF2		1.75					49.6	139	23.2	21.7																	
	2.0EF2		2.0					55.8	159	26.5	24.8																	
	2.5EF2		2.5					71.5	199	33.2	31																	
3.0EF2	3.0		85.2					239	39.84	37.3																		
4.0EF2	4.0	112	318	53	49.6																							
1.0F2	2000	1.0	φ480	12	φ12	15	34	80	13.34	13.8	1650																	
1.6F2		1.6					53	127	21.2	22																		
1.75F2		1.75					54.9	139	23.2	24																		
2.0F2		2.0					63.5	159	26.5	27.5																		
2.5F2		2.5					80	199	33.2	34.4																		
3.0F2		3.0					92	239	39.84	41.3																		
4.0F2	4.0	123	318	53	54.9																							

绳槽参数 THE PARAMETER LIST OF GROOVE

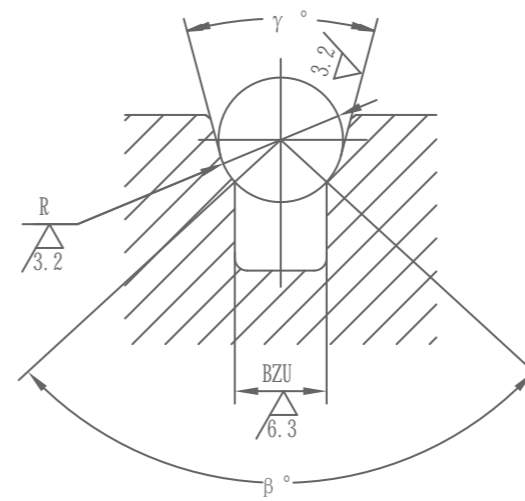

单绕槽型
(Single groove)

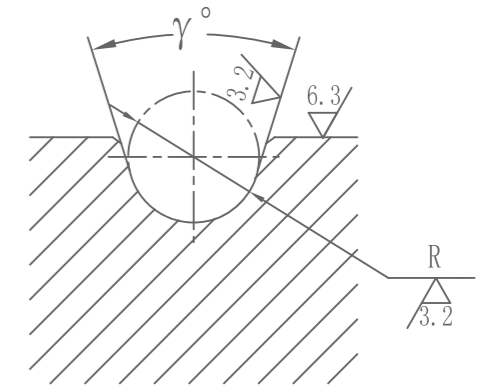

复绕槽型
(Double groove)

槽型 (Groove)	R	β	γ	BZU
单绕槽型 (Single groove)	φ6	90°	35°	4.24
	φ8	90°	35°	5.66
	φ10	97°	25°	7.49
	φ12	95°	35°	8.85
复绕槽型 (Double groove)	φ10		35°	
	φ12		35°	
	φ16		35°	

钢带系列 SYLG-EB

HOISTING BELT SERIES

SYLG-EB

电梯曳引钢带

SYLG-EB Hoisting Belt for Elevator

蓝光拥有从精密镀锌钢丝绳到电梯曳引钢带的完整生产线。电梯钢带年产能 200 万米。基于电梯曳引钢带测试与认证的需求，公司研发中心投入了全套测试设备，支持产品研发及客户合作。

Bluelight has complete production lines from precise galvanized steel rope to elevator traction belt. The annual production capacity of elevator steel belt is 2 million meters. R&D center has invested full sets of testing equipment for elevator traction belt examination and certification, as well supporting product development and customer cooperation.



应用方案 (Application)

使用不同钢带所需要的根数 Number of belt with different model				
电梯载重量 Load(kg)	曳引比 Roping Ratio	32kN	43kN	64kN
630	2:1	2		
800	2:1	3		
1000	2:1	4	3	
1250	2:1	5	4	
1600	2:1	6	6	3

- 按 12 倍安全系数计算；
- 标称强度为钢带保留一定安全余量的最小破断力；
- 使用 3 根钢带最为经济高效。
- Calculated by safety factor of 12.
- Nominal strength is counted by minimum breaking force with safety margin.
- Using 3 belts is the most economic efficiency.

特点 (Features)

- 全系列产品选用BASF Elastogran 高硬度聚氨酯，具备优秀的机械及化学性能。
- 使用世界一流工艺生产的精密镀锌无接头钢丝绳，成型均匀，具有优秀的耐疲劳、抗腐蚀能力。
- 潜心研发的表面处理技术，当量摩擦系数更加稳定，面对各种工况皆应对自如。
- 在线轮廓扫描系统，实时监控外形尺寸，确保每一米钢带品质如一。
- 钢带开发过程经过严格疲劳测试，弯曲疲劳寿命达到1000万次以上。
- 独有 SITONADH™ 表面涂胶精密镀锌钢丝绳芯，钢丝绳与聚氨酯的结合力超过国标10倍以上，规避钢带脱层、开裂风险。
- All series products use BASF Elastogran high hardness TPU, it has excellent mechanical and chemical features.
- World class technic to produce high precision galvanized no joint steel rope, with uniform shaping, high fatigue durability and corrosion resistance.
- Focus on surface treatment, equivalent friction coefficient is stable and capable of handling complicated working conditions.
- Online contour scanning system, real-time monitoring of external dimensions to ensure the same quality of every meter of traction belt.
- Traction belt under strict fatigue test during development process. Life time is more than 10 million times bending test.
- Unique SITONADH™ surface coating for precise galvanized steel core, the bonding force of the steel core and polyurethane exceeds 10 times the national standard, avoiding the risk of delamination and cracking of the steel belt.

32kN Hoisting Belt for Elevator (SYLG-EB-32A)

Item	Unit	Standards
Min Force	kN	32
Width	mm	30
Thickness	mm	3.0
Number of steel core	-	12
Steel core diameter	mm	1.61
Strength of steel core	N	3000
Min bending diameter	mm	80
Weight per meter	g/m	200

32kN Grade Traction Belt

- Suitable for low to medium floor passenger elevators, villa elevators and most elevator applications.
- 30mm width, common size in the market.
- 2:1 and 1:1 roping ratio.
- 12 hyperfine steel cores with only 1.6mm diameter.

34kN Hoisting Belt for Elevator (SYLG-EB-34A)

Item	Unit	Standards
Min Force	kN	34
Width	mm	25
Thickness	mm	3.3
Number of steel core	-	8
Steel core diameter	mm	1.98
Strength of steel core	N	4550
Min bending diameter	mm	100
Weight per meter	g/m	190

34kN Grade Traction Belt

- Suitable for low speed villa elevators.
- Lighter, stronger and more economic.
- 2:1 roping ratio.
- 25mm width applications.
- 8 high precision steel cores with 1.98mm diameter.

43kN Hoisting Belt for Elevator (SYLG-EB-43A)

Item	Unit	Standards
Min Force	kN	43
Width	mm	30
Thickness	mm	3.3
Number of steel core	-	10
Steel core diameter	mm	1.98
Strength of steel core	N	4550
Min bending diameter	mm	100
Weight per meter	g/m	230

43kN Grade Traction Belt

- Suitable for commercial elevators, medium to high floor passenger elevators and heavy load villa elevators.
- 30mm width, common size in the market.
- 10 high precision steel cores with 1.98mm diameter.

64kN Hoisting Belt for Elevator (SYLG-EB-64A)

Item	Unit	Standards
Min Force	kN	64
Width	mm	60
Thickness	mm	3.0
Number of steel core	-	24
Steel core diameter	mm	1.61
Strength of steel core	N	3000
Min bending diameter	mm	80
Weight per meter	g/m	400

64kN Grade Traction Belt

- Suitable for freight elevators, bed elevators and heavy load passenger elevators.
- 60mm width, requires high installation quality.
- 24 hyperfine steel cores with only 1.6mm diameter.